



Facility Name: Rydges Tradewinds Cairns

Facility Type: Resort

**Facility Address: 137 The Esplanade,
PO Box 396, Cairns 4870**

**Phone: 07 4053 0300 – within Australia
+61 7 4053 0300 – International**

**Fax: 07 40 51 8649– within Australia
+61 7 4051 8649 – International**

Email: reservations_esplanadecairns@rydges.com

Website: www.rydges.com

Room numbers: two accessible rooms, one with interconnecting room

Recommended:

Recommended for ambulant and wheel chair users with a high level of function.

Parking:

There are four designated accessible parking bays in the car park on the ground floor at the back of the resort.



Entry into reception

Entry into reception is through double automatic doors measuring 2200mm wide, leading into a large level tiled and carpeted area with ample seating. The reception desk does not have a lowered section for wheel chair users, but staff are very friendly and will assist where necessary.

Access to public areas



This lounge is before reception and the dining room and bar are off the right in the same area. The internet room is behind the reception.



Entry into the restaurant and bar is all level and there is level access to the pool, but there are no means of entry except the steps into the pool.



Accommodation:

The accessible guest rooms are on the second floor.

The door into the lift is 1000mm wide and the internal measurement of the lift is 1940mm wide and 1320mm long. There is no verbal announcement for stops at each floor and the buttons are not Braille, but are raised.



The door handle is a D handle, with a clear opening width of 766mm and can be opened with one hand.



Room furniture can be moved to suit the guest's requirements, just notify staff when booking and they will be more than happy to assist.
The bed room has one queen size bed with the widest space at the side of the bed being 2000mm. Under bed clearance is 110mm and the height to the top of mattress is 530mm.



There is a coffee/tea making facility in the room.
The TV can be controlled by remote from the bed.
The height of the cupboard clothes rail is 1700mm above the floor.

Sanitary Facilities:

Entry into the accessible shower and toilet is through a 766mm clear opening door which has a slight ramp as shown in the photo.



The facility is a combined toilet and shower with a dimension of 2450mm long by 1860mm wide.

The space between the toilet and the wash basin is 520mm as shown in the photo.



There is a horizontal grab rails fitted beside the toilet which measure 820mm from the floor. The toilet measures 470mm from the wall to the centre of the toilet seat and the seat is 420mm from the floor.



The shower has both vertical and horizontal grab rails, the shower rose is mounted high but is on a sliding rail. Clearance to the under side of the sink is 645mm with a height to top of sink at 775mm. The base of the mirror from floor is 1050mm.

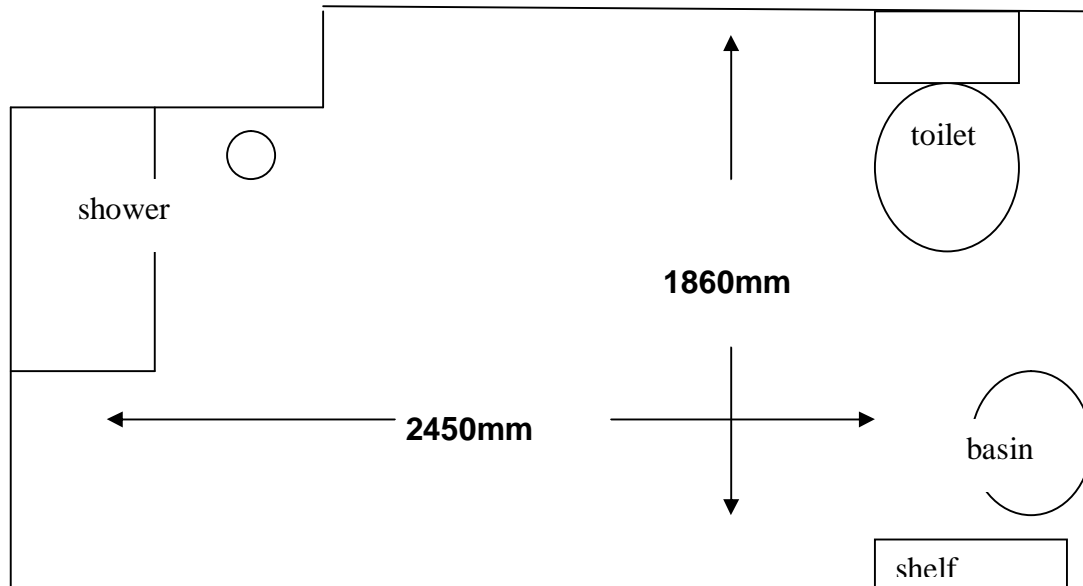

Diagram not to scale.

General:

Staff are very friendly and will assist with baggage if required.

There is no emergency call system in the bathroom.

Assistance dogs are welcome on the premises.