



Facility Name: Bohemia Resort

Facility Type: Backpackers Resort

Facility Address: 231 McLeod St, Cairns

**Phone: 07 4041 7290 – within Australia
+61 7 4041 7290 – International**

**Fax: 07 4041 7292 – within Australia
+61 7 4041 7292 – International**

Email: info@bohemiaresort.com.au

Web:

Room numbers: One accessible 6 bed bunk room



Parking:

There are no designated accessible parking bays but there is parking immediately in front of reception or there is lots of on street parking.

Entry into reception

Entry into reception is through double sliding doors into an open level area with no steps or thresholds. The reception desk does not have a lowered section for wheel chairs but staff are very friendly and will assist where necessary. Within reception you will find a tour desk and internet café for your convenience.



Level entry into reception



Reception counter and friendly staff



Internet café



Tour desk

Access to public areas

Entry into the Pool area, BBQ's, Bar, Kitchen and Games Room is over level access through the pool gate. Some visitors may need assistance reaching the pool gate latch.

The Pool bar and pool is close to the accessible accommodation and the paths are level and well constructed making access easy.

The kitchen workstations are reasonably accessible and can be operated with little fuss.



Pool area



Kitchen



Pool Bar



Bar area



Games room



Relaxed outdoor area near pool



Accommodation:

The accessible guest room is located close to reception on the ground floor. Access into the room is over a level threshold with no sills, the door width is 820mm clear opening. The doors are light and easy to open with D style levers and no force required to push the doors open.

The bedroom is dorm style with eight single beds. Under bed clearance is 260mm and the height to the top of mattress is 430 mm. There is 2m of clear space between beds.

There is a writing desk provided with a height to the top of the desk at 730mm and a clear height from the floor of 700mm. There is a small bar fridge provided for use. The room is equipped with ceiling fans and does not have cupboard storage. Light switches are positioned 1060mm from the floor.



Entry into accessible room



Bed layout in room



Divider between sets of beds



Sanitary Facilities:

Entry into the accessible shower and toilet is through a 820mm clear opening door. The facility is a combined toilet and shower with a dimension of 2280mm long by 1900mm wide. There is a drop down shower seat provided and it is mounted at 590mm from the floor, 900mm long and 360mm wide. A shower commode can be hired from Phoenix Medical and Prescription and delivered to the resort if required. Contact Phoenix on 4041 3629. Horizontal and vertical grab rails are provided and the shower rose is adjustable with flick mix tap.

Grab rails are fitted to the toilets and are mounted 850mm from the floor to top of grab rail. The height from the floor to the top of the pan seat is 430mm and 430mm from wall to centre of seat. The sink is located 1150mm from the front of the pan.

Clearance to the under side of the sink is 670mm with a height to top of sink at 780mm, the sink is fitted with a flick mix tap.

No emergency call button provided in the shower and toilet.



Accessible Shower



Accessible toilet



Sink

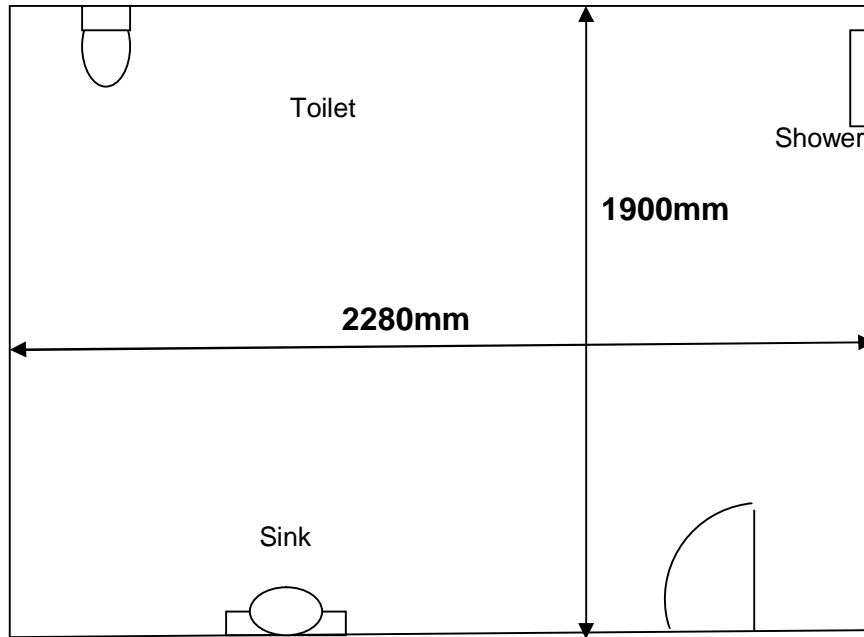

Diagram not to scale.

General:

Staff are very friendly and will assist with baggage if required.

Assistance dogs are welcome on the premises.

The resort is close to the CBD and many restaurants and shops. The reef fleet terminal, Kuranda scenic rail Station is also very close by.

The resort is vibrant and you can be assured of having a good time whilst visiting the resort.